



McDonald's®
**Kanga
cup**

DRIBL GUIDE FOR GAME DAY (APP VERSION)

FOR MANAGERS AND COACHES

Do you have the Dribl app and have used Dribl before?

If yes:

- You should be able to see your team in the FOLLOWING tab on your app.
- If you can't see your team, email us at competitions@kangacup.com

If you have Dribl account but used a different email to register your team, please contact us at competitions@kangacup.com

If you have never used the Dribl app:

- Download the Dribl app
- You will need to self-register. You can do that by following the [guide here](#)
- Once you have self-registered, your team will appear in the FOLLOWING tab on your app
- If you have troubles seeing your team, please contact us at competitions@kangacup.com

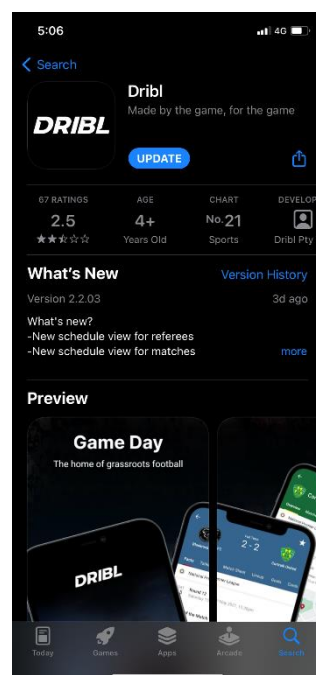

Pre Game

TO BE COMPLETED BY THE HOME AND AWAY TEAM COACH OR MANAGER

SUBMIT AND CONFIRM YOUR TEAM

1. Login to Dribl as a coach, manager or team official

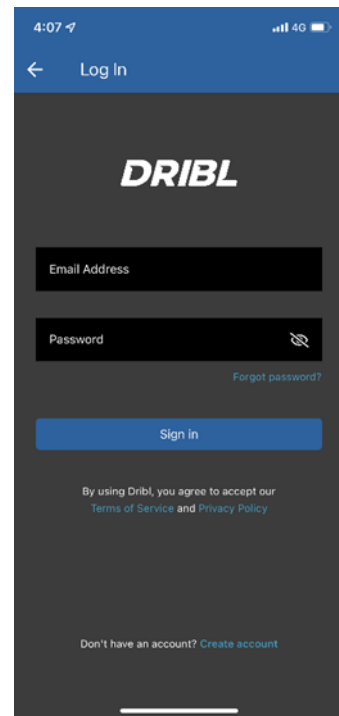

2. Click on Fixtures tab and find the applicable fixture
 - Click on that fixture
3. Click on 'Home Team' or 'Away Team'
 - This will depend on whether you are home or away for that specific fixture

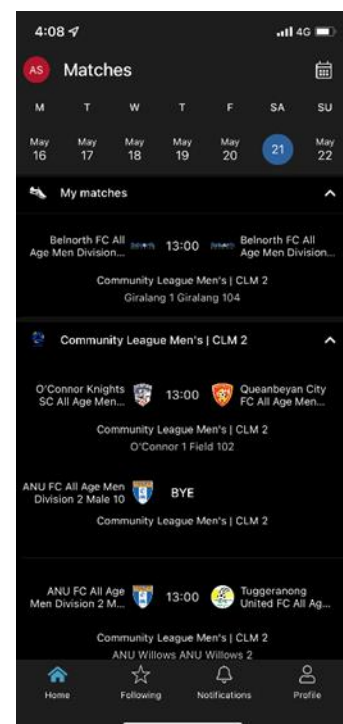

4. Submit Team. This means you need to allocate:
 - Players, coaches and officials for that game
 - Who the captain is,
 - You can also View, modify or define Jersey numbers

NOTE: This must be done no later than 30 MINUTES BEFORE KICKOFF

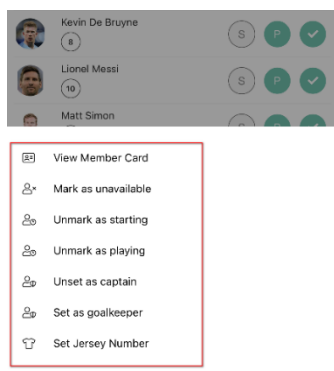

You do this by clicking and holding down on the player's name.

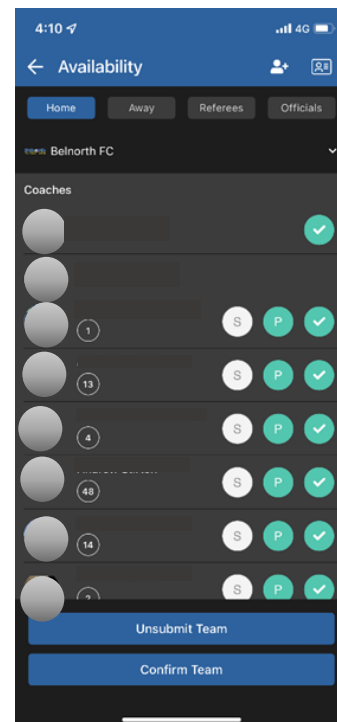

5. Once all steps have been completed you then click "Submit Team"

NOTE: This must be done no later than 10 MINUTES BEFORE KICK OFF.

- Both the Home and Away team must confirm the opposition team prior to the commencement of the game. This is done by going into the opposition tab and pressing the 'Confirm Team' button at the bottom of the app.
- If you wish you make any changes to your submission, this can be done by clicking 'Unsubmit Team', make the necessary changes and clicking 'Submit Team' again.

NOTE: if both teams have been confirmed, both the Home and Away teams will need to unconfirm their teams to make any changes. Both teams will need to re-confirm their teams after changes have been made.

Once the pre-game match sheet has been completed; this is what it should look like.

